

REVISED LAYOUT PLAN OF INDUSTRIAL POCKET MADHUBAN-BAPUDHAM SCHEME AT NH-58 GZB.

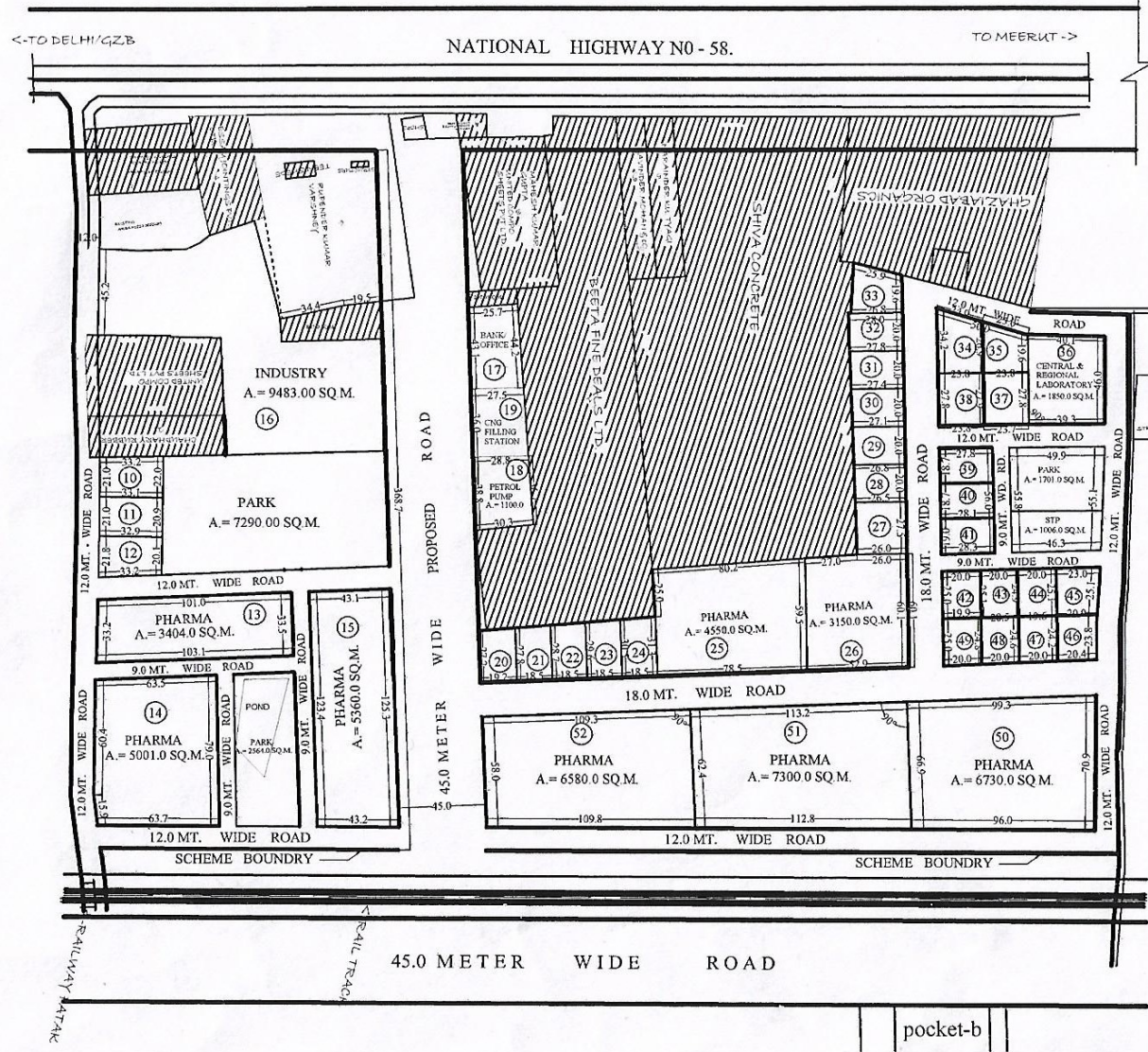

AREA DETAIL
 AREA OF SCHEME = 114476.0 SQ.M.
 (EXCLUDING 45.0 MT. WIDE PROPOSED ROAD)
 AREA UNDER PLOT = 73925.0 SQ.M.
 AREA UNDER S.T.P. = 1006.0 SQ.M.
 AREA UNDER PARK = 11555.0 SQ.M.
 AREA UNDER ROAD = 27990.0 SQ.M.

PLOT NO.	USE	AREA (APPROX) Sq.M.
10 to 12	INDUSTRIAL	692.00 (EACH)
13	PHARMA	3404.00
14	PHARMA	5001.00
15	PHARMA	5360.00
16	INDUSTRY	9483.00
17	BANK/OFF.	1158.00
19	C.N.G. FILL ST.	1012.00
18	PETROL PUMP	1100.00
20 to 24	INDUSTRIAL	540.00 (EACH)
25	PHARMA	4550.00
26	PHARMA	3150.00
27	INDUSTRIAL	525.00
28	INDUSTRIAL	533.00
29	INDUSTRIAL	539.00
30	INDUSTRIAL	545.00
31	INDUSTRIAL	552.00
32	INDUSTRIAL	558.00
33	INDUSTRIAL	527.00
34	INDUSTRIAL	743.90
35	INDUSTRIAL	567.70
36	CENT REG. LAB.	1850.00
37	INDUSTRIAL	661.41
38	INDUSTRIAL	662.83
39	INDUSTRIAL	519.86
40	INDUSTRIAL	525.47
41	INDUSTRIAL	535.80
42	INDUSTRIAL	498.78
43	INDUSTRIAL	500.00
44	INDUSTRIAL	500.00
45	INDUSTRIAL	550.94
46	INDUSTRIAL	495.60
47	INDUSTRIAL	483.12
48	INDUSTRIAL	506.35
49	INDUSTRIAL	496.75
50	PHARMA	6730.00
51	PHARMA	7300.00
52	PHARMA	6580.00